

Typical Rack and Pinion Power Assisted Steering System

C-III PUMP
3A674
(NOTE: SOME SYSTEM
APPLICATIONS UTILIZE
C-II PUMP)



STEERING COLUMN
3C524



RACK AND
PINION GEAR
3504



C-III PUMP RESERVOIR
3R700 / 3E764

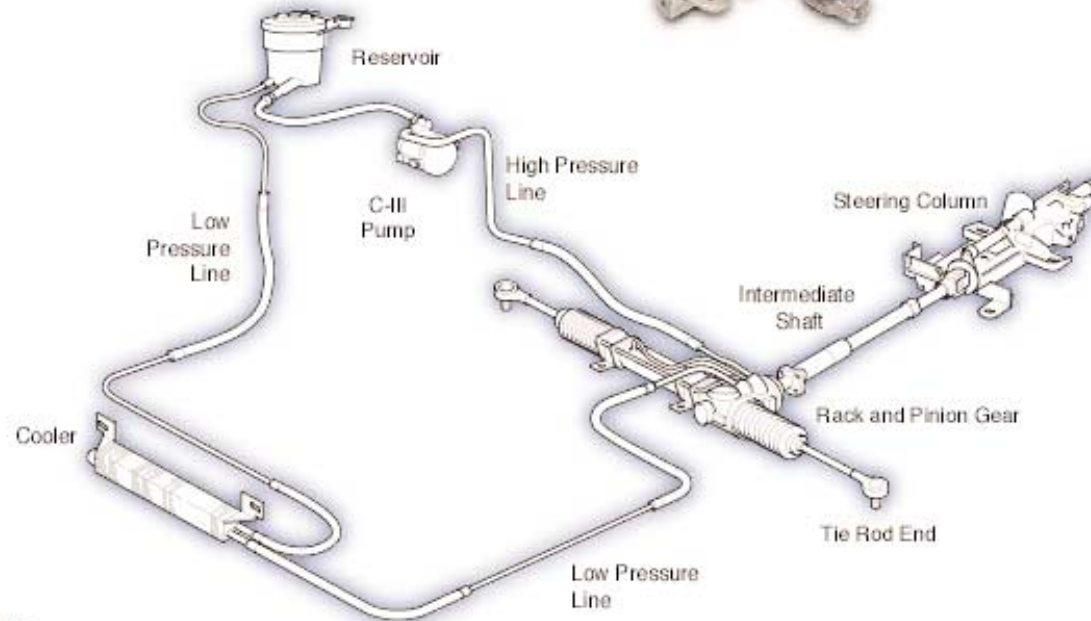

INTERMEDIATE
SHAFT 3B676



LOW PRESSURE
LINES 3A713

HIGH PRESSURE
LINES 3A719



COOLER ASSEMBLY
3D764



VARIABLE ASSIST
POWER STEERING
(VAPS) 3N803

A/C BLOWER MOTOR INSTALLATION

OLD

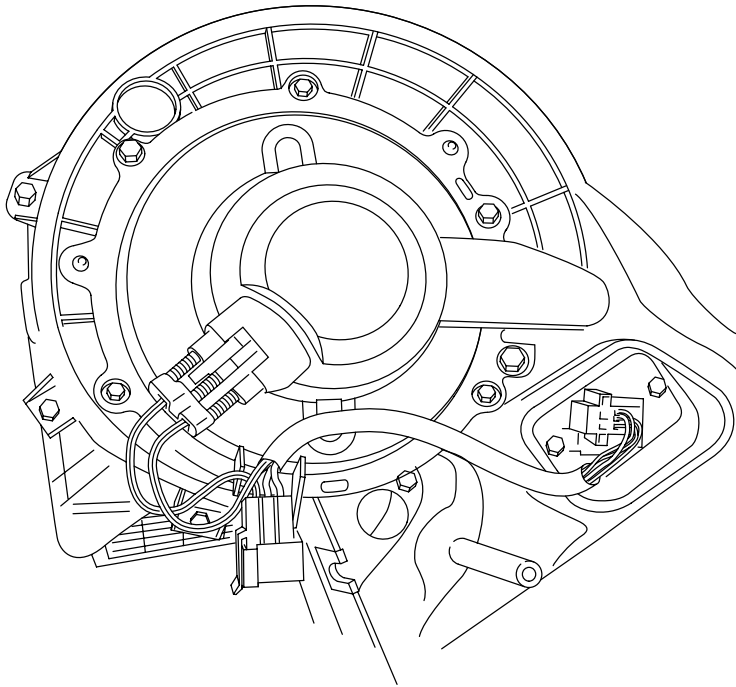

This kit contains a new style blower motor that incorporates the motor and cover into one piece. Replace old style motor with new, being sure to plug extra mounting hole with left over screw to avoid any noise or air leakage.

NEW

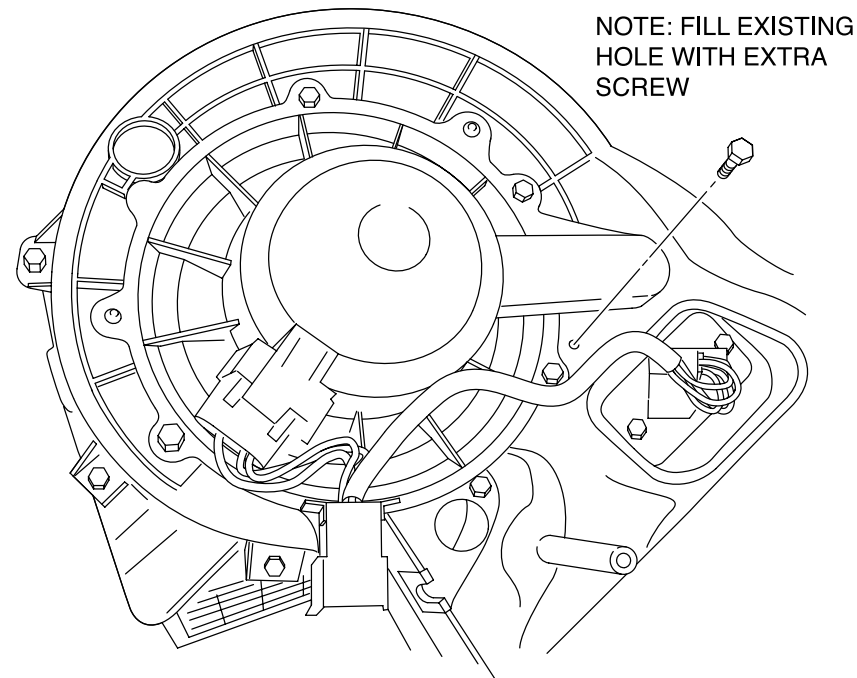

CABLE PLENUM CONNECTION

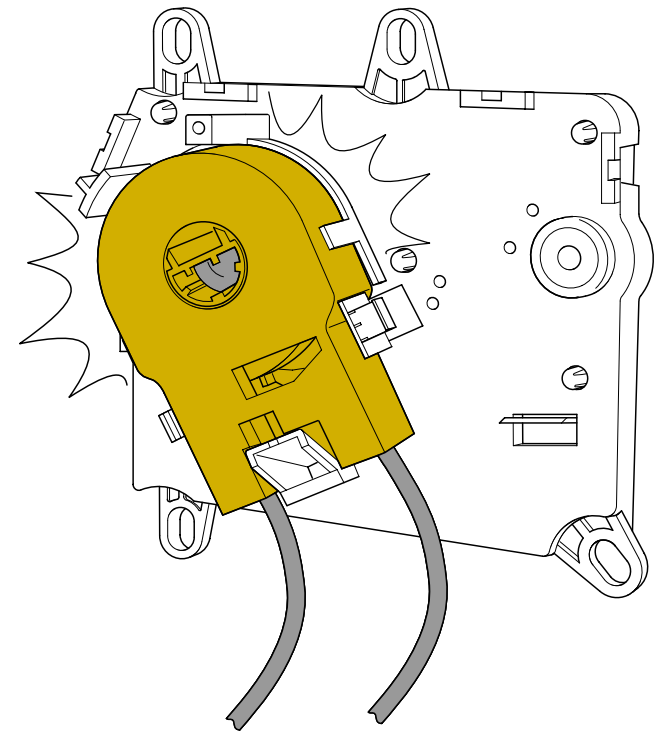
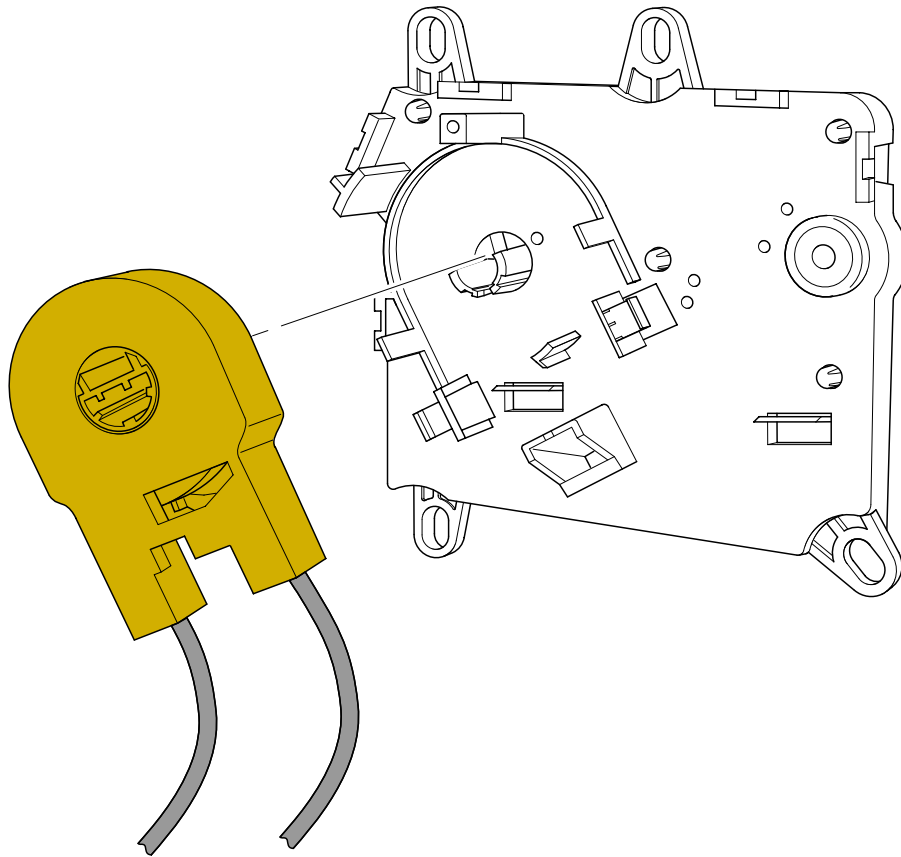

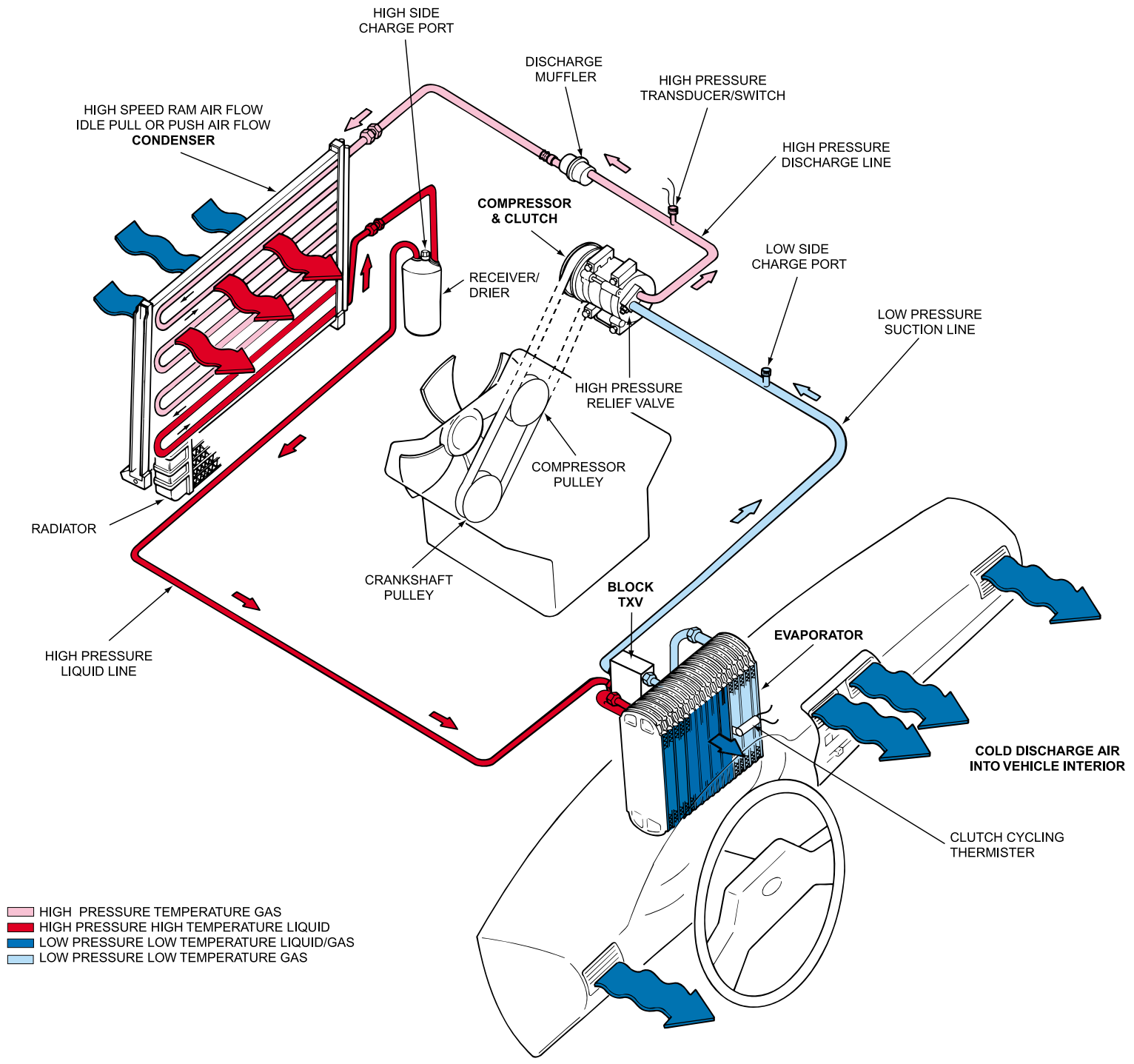

VACUUM LINE CONNECTION FOR PROPER A/C AND 4 X 4 OPERATION

